

The Bomb Factory



Our largest venue on the island is a converted World War I torpedo store.

With exposed brick walls and industrial architecture, The Bomb Factory echoes its fascinating history, complemented by outdoor spaces and sea views.

This all-purpose space presents a blank canvas for grand scale events.



Osea Island



Osea Island



Osea Island



Osea Island

Capacity

Standing

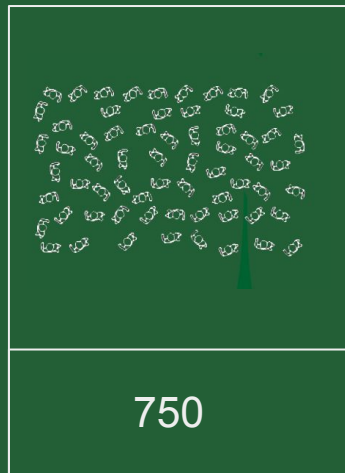

Theatre

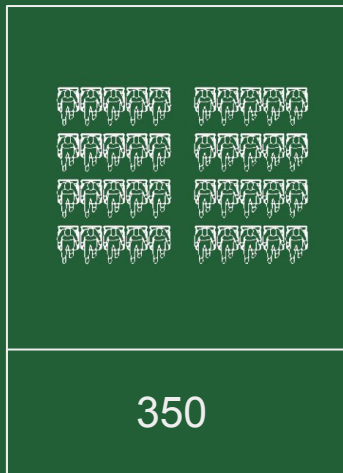

Banquet

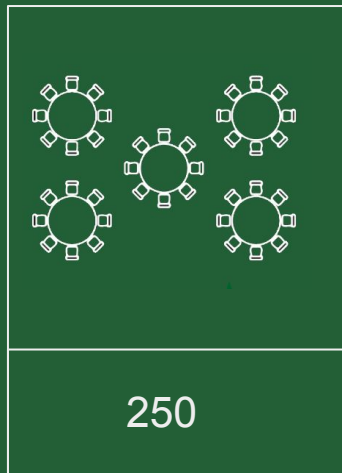

Classroom

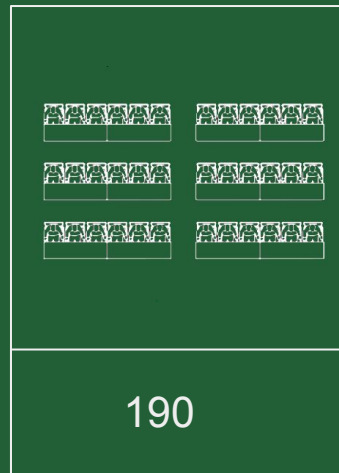

Boardroom

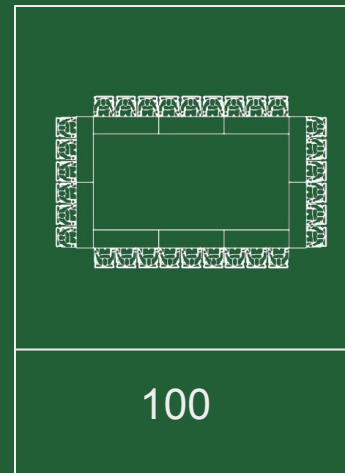

Facilities

- Fully soundproofed
- Professional catering kitchen
- Outdoor terrace and gardens for increased capacity

Floor plan

Gross. Internal Floor Area-
8409 sq ft/781 sq m

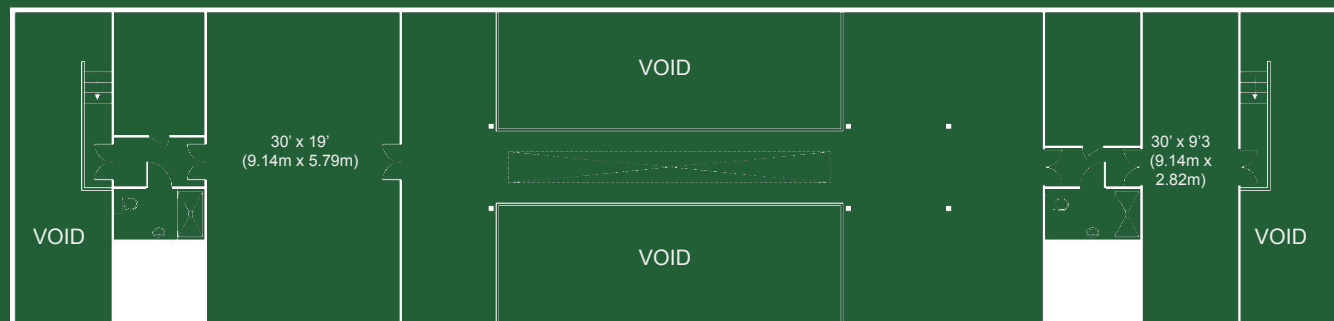

First Floor

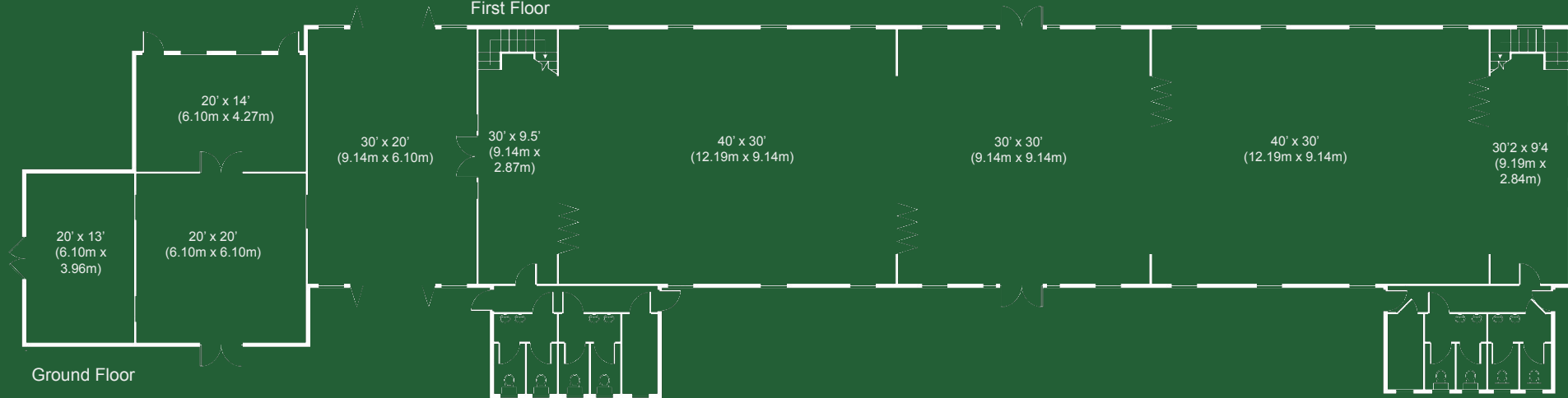

Ground Floor

Osea Island