

The Shack



The Shack is a remnant of the naval base, S.S. Osea, that operated during the First World War.

Reimagined as a party venue, The Shack's eclectic and playful decor is great fun for drinks and gatherings.

This fully soundproofed venue has no curfew, making it the ultimate after party destination.



Osea Island



Osea Island



Osea Island

Floor plan

Gross. Internal Floor Area-
1456 sq ft/135 sq m

Key features

Soundproofing
Air conditioning and heating
Flexible outdoor capacity
Fire pits
Bar

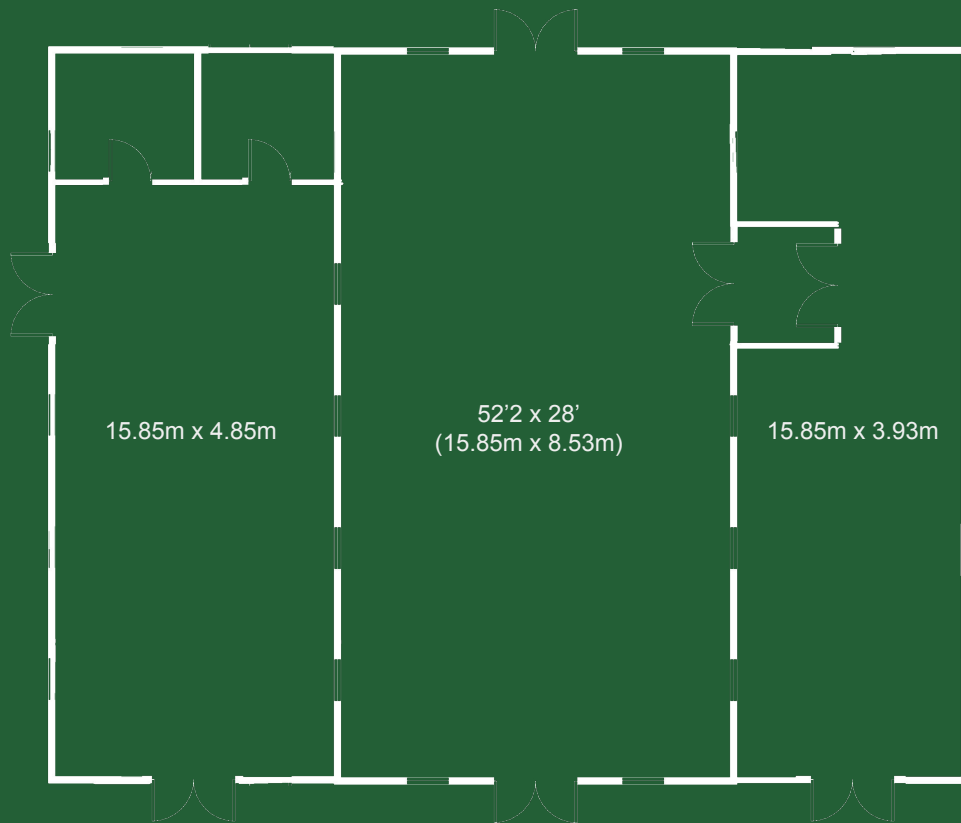

Osea Island

Capacity

Standing

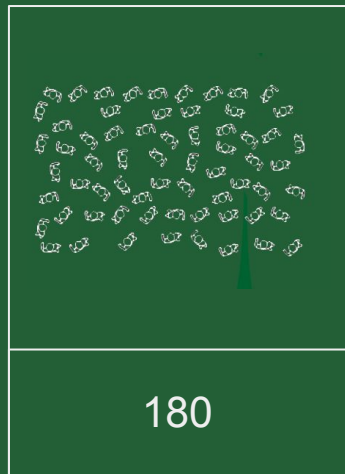

Theatre

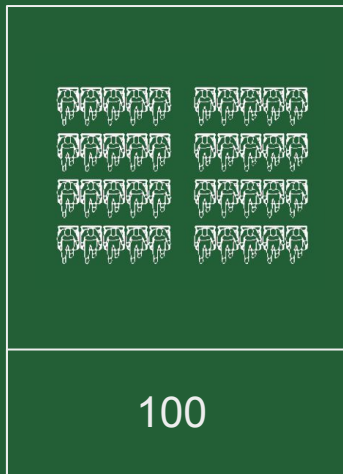

Banquet
(exterior pergola)

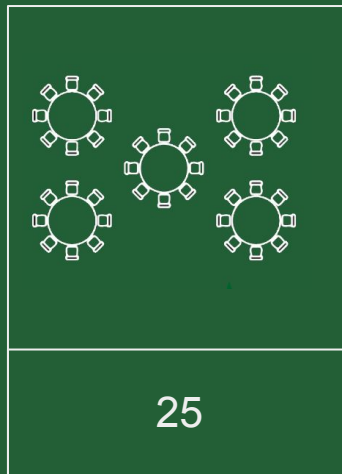

Classroom

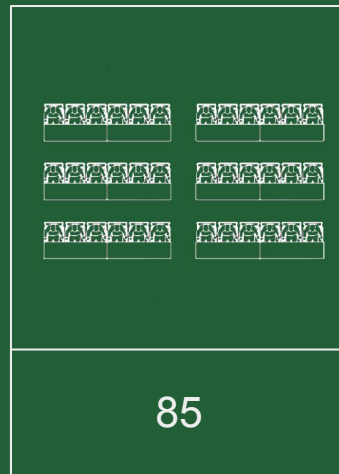

Boardroom

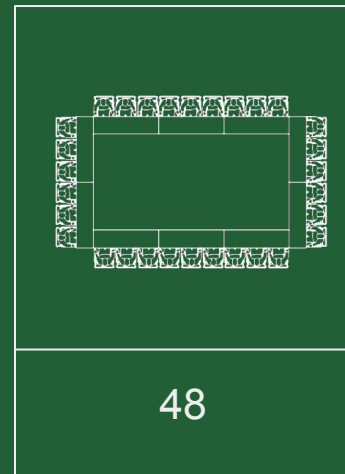

The Shack outdoor area accommodates an additional 220 people